



# PZW75 Column Compression Load Cell

## Features

- Column structure, easy installation and reliable performance.
- Alloy steel construction, surface nickel plated treatment.  
option: stainless steel material.
- Capacity: 20t to 40t.
- Welded sealing, oil-proof, waterproof and anti-corrosion.
- High accuracy, good self-aligning, anti-lightning.
- Suitable for atrocious environment.



## Applications

- Electronic truck scales
- Hopper scales
- Automotive testing equipments
- Electronic platform scales

## Specifications

Parameter	Units	Data
capacity	t	20, 30, 40
safe overload	%fs	150
ultimate overload	%fs	200
output sensitivity at fs	mV/V	2.0 ±0.04
zero unbalance	%fso	≤ ±1
combined error	%fs	≤ ±0.03
creep error (30 min.)	%fs	≤ ±0.02
excitation (supply voltage)	Vdc	10 (typical), 5, ..., 12
max. excitation voltage	Vdc	15
input resistance	Ω	720 ±15
output resistance	Ω	700 ±10
insulation resistance	MΩ	≥ 5000@50 Vdc
storage temp. range	°C	-35 ~ +65
operating temp. range	°C	-35 ~ +65
compensated temp. range	°C	-10 ~ +40
temp. coefficient of sensitivity	%fso/10°C	≤ ±0.03
temp. coefficient of zero	%fso/10°C	≤ ±0.02
load cell body material	/	alloy steel (standard),option: 17-4PH
mechanical interface	/	refer to the dimensions on the datasheets
electrical interface	/	Φ5.7mm, 4-conductor shielded, PVC jacket, length: 12m
environment protection	/	IP67

For customized capacity, please consult Proza.

## Proza Electronic Technology



# PZW75 Column Compression Load Cell

## Dimensions

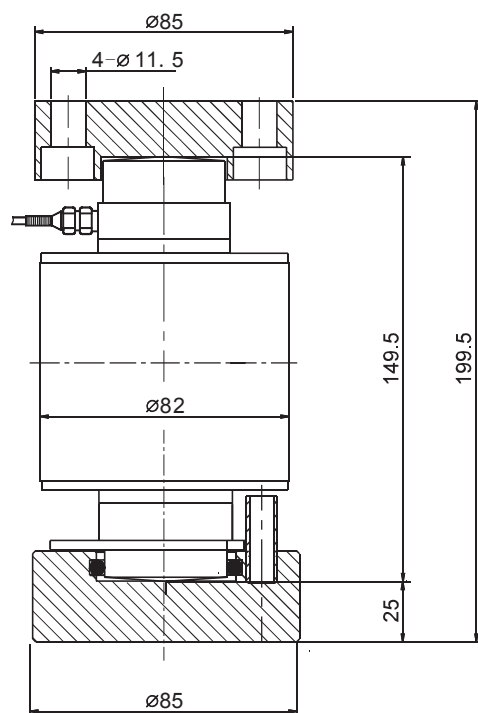

## Electrical connection

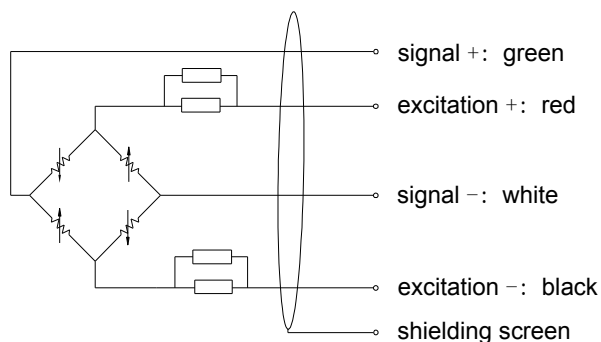

## Ordering Guide

### ordering code:

model-capacity-output sensitivity-accuracy-cable length-(\*customized parameter)

### example:

PZW75-30t-2mV/V-0.03%fs-12m

## Proza Electronic Technology