



PZTO12 Static Torque Transducer

Features

- Strain gauge technology
- Range from 2 Nm to 3000 Nm
- Accuracy up to 0.1%fs
- Alloy steel
- Environment protection IP67

Applications

- Torque wrench and torsion measurement of shaft
- Vehicle testing



Specifications

Parameter	Units	Data
measuring range	Nm	2, 5, 10, 20, 50, 100, 200, 300, 500, 1000, 2000, 3000
safe overload	%fs	150
ultimate overload	%fs	200
output sensitivity at fs	mV/V	1~1.5
zero unbalance	%fso	≤ ±1
combined error	%fs	0.1, 0.25 (standard)
creep error (30 min.)	%fs	±0.05
excitation (supply voltage)	Vdc	10 (typical), 5, ..., 12
max. excitation voltage	Vdc	15
input resistance	Ω	380 ±10, 750 ±30
output resistance	Ω	350 ±3, 700 ±5
insulation resistance	MΩ	≥ 5000@50 Vdc
storage temp. range	°C	-35 ~ +65
operating temp. range	°C	-20 ~ +65
compensated temp. range	°C	-10 ~ +40
temp. coefficient of sensitivity	%fso/10°C	±0.05
temp. coefficient of zero	%fso/10°C	±0.05
load cell body material	/	Alloy steel
mechanical interface	/	refer to the dimensions on the datasheets
electrical interface	/	Φ5.7mm, 4-conductor shielded, PVC jacket, length: 13m
environment protection	/	IP67

For customized measuring range, please consult Proza.

Proza Electronic Technology



PZTO12 Static Torque Transducer

Dimensions

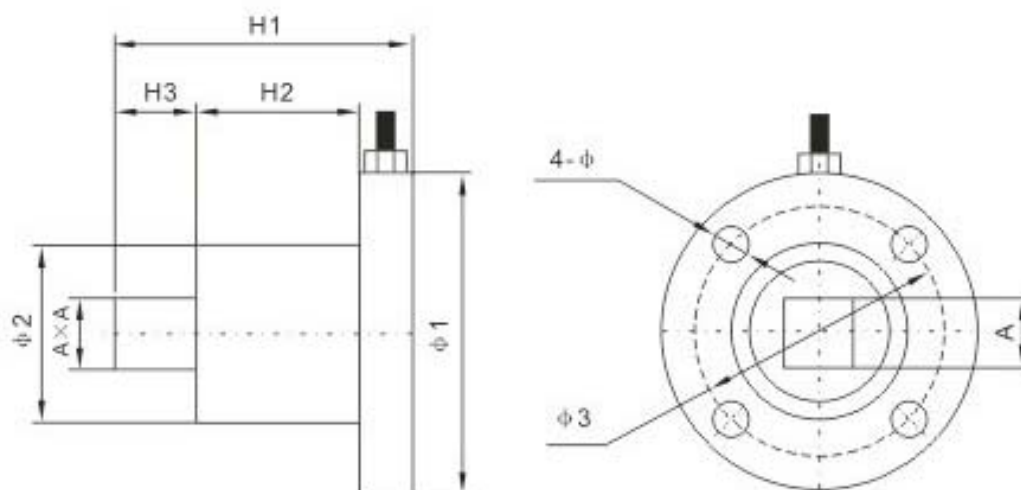

Cap.N. m \ Size mm	A	H1	H2	H3	φ1	φ2	φ3	φ
2~200	12.5	55	30	15	59	32	45	6.5
300~1500	25.4	75	40	24	68	40	55	8.5
2000~3000	25.4	85	44	24	98	56	80	13

Electrical connection

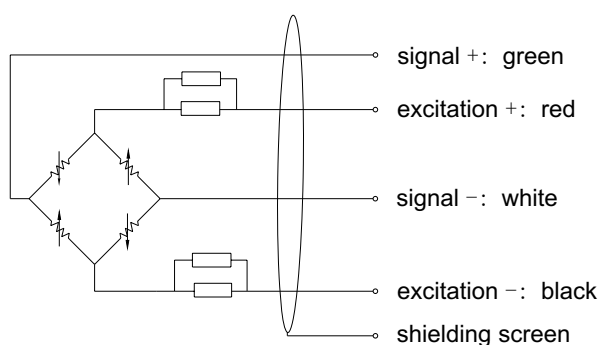

Ordering Guide

ordering code:

model-measuring range-output sensitivity-accuracy-cable length-(*customized parameter)

example:

PZTO12-50Nm-1mV/V-0.25%fs-13m

Proza Electronic Technology